

### UNI CUT 729

#### SOLID CARBIDE SINGLE ANGLE SHELL END MILL

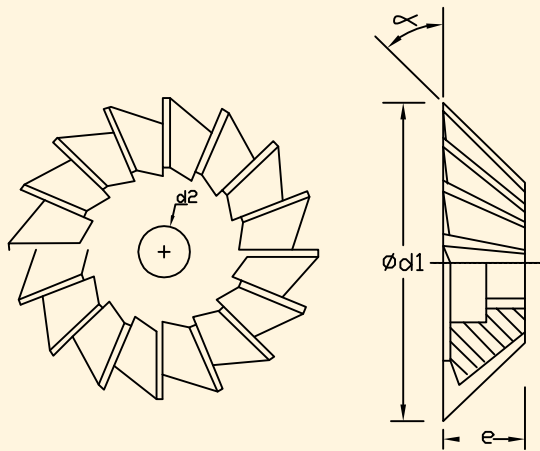

Order No.	$\alpha$	d1	e	d2	Prices
729 - 040 - 45	45°	40	10	10	
729 - 050 - 45	45°	50	13	13	
729 - 063 - 45	45°	63	18	16	
729 - 080 - 45	45°	80	22	22	
729 - 100 - 45	45°	100	28	27	
729 - 125 - 45	45°	125	36	32	
729 - 160 - 45	45°	160	45	40	
729 - 040 - 50	50°	40	13	10	
729 - 050 - 50	50°	50	16	13	
729 - 063 - 50	50°	63	20	16	
729 - 080 - 50	50°	80	25	22	
729 - 100 - 50	50°	100	32	27	
729 - 125 - 50	50°	125	40	32	
729 - 160 - 50	50°	160	50	40	
729 - 040 - 55	55°	40	13	10	
729 - 050 - 55	55°	50	16	13	
729 - 063 - 55	55°	63	20	16	
729 - 080 - 55	55°	80	25	22	
729 - 100 - 55	55°	100	32	27	
729 - 125 - 55	55°	125	40	32	
729 - 160 - 55	55°	160	50	40	
729 - 040 - 60	60°	40	13	10	
729 - 050 - 60	60°	50	16	13	
729 - 063 - 60	60°	63	20	16	
729 - 080 - 60	60°	80	25	22	
729 - 100 - 60	60°	100	32	27	

### UNI MILL 735

#### SOLID CARBIDE SHELL END MILLS

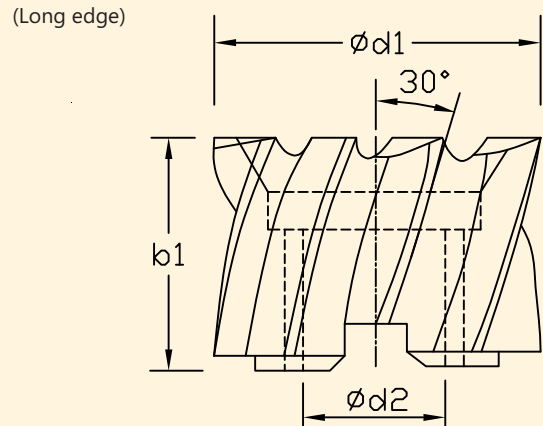

Order No.	Dia d1	1D d2	Short length b1	Medium length b1	Long Edge b1	Prices
735 - 0250	25	16	50	75	100	
735 - 0320	32	20	50	75	100	
735 - 0400	40	20	70	90	120	
735 - 0500	50	25	70	90	125	
735 - 0600	60	25	80	100	130	
735 - 0750	75	32	80	100	130	
735 - 0800	80	32	80	100	130	
735 - 0900	90	40	90	110	140	
735 - 1000	100	40	100	120	150	
735 - 1200	120	40	100	120	150	
735 - 1250	125	40	100	120	150	
735 - 1400	140	40	110	130	160	
735 - 1500	150	40	120	140	180	
735 - 1600	160	50	130	150	190	
735 - 1700	170	50	140	160	200	

World Class Tools From  
World Class Universal Tool

### UNI MILL 744

#### SOLID CARBIDE BACK AND FRONT CHAMFER TOOL

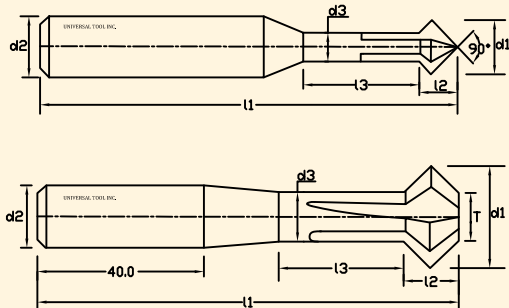

### UNI MILL 742

#### SOLID CARBIDE CHAMFER CUM COUNTER SINK TOOL

WITH 60°, 90°, 120° Point angle 2FL-  
Offered in 3FL & 4FL design also offered with thro' coolant.

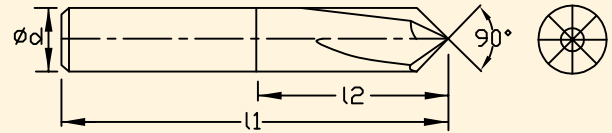

Angle 90° Small 3 / flutes

Order No.	d1	d2	d3 max	T max	L1	L2	L3 min
744 0010-S90	1.0	3	0.7	0.30	60	0.50	5
744 0015-S90	1.5	3	1.1	0.45	60	0.73	6
744 0020-S90	2.0	3	1.5	0.60	60	0.95	8
744 0030-S90	3.0	3	2.1	0.90	60	1.50	10

Angle 90° Big 4 / flutes

Order No.	d1	d2	d3 max	T max	L1	L2	L3 min
744 0030-B90	3.0	6	2.2	1.2	100	1.30	10
744 0040-B90	4.0	6	2.9	1.6	100	1.30	10
744 0050-B90	5.0	6	3.4	2.0	100	1.30	10
744 0060-B90	6.0	6	3.8	2.4	100	1.30	10
744 0080-B90	8.0	6	4.9	4.9	100	1.30	10
744 0100-B90	10.0	6	5.9	5.9	100	1.30	10
744 0120-B90	12.0	6	5.9	5.9	100	1.30	10
744 0160-B90	16.0	10	7.9	7.9	100	1.30	10

Angle 60° 4 / flutes

Order No.	d1	d2	d3 max	T max	L1	L2	L3 min
744 0050-A60	5.0	6	3.4	3.4	100	2.8	15
744 0080-A60	8.0	6	4.9	4.9	100	5.4	14
744 0120-A60	12.0	6	5.9	5.9	100	10.6	34

Order No.	d	L	L2	Prices
742- 0680	6	80	15	
742- 0880	8	80	15	
742- 0810	8	100	20	
742- 1080	10	80	20	
742- 1010	10	100	20	
742- 1012	10	125	20	
742- 1015	10	150	20	
742- 1280	12	80	20	
742- 1210	12	100	20	
742- 1212	12	125	20	
742- 1215	12	150	20	
742- 1480	14	80	20	
742- 1410	14	100	20	
742- 1412	14	125	20	
742- 1415	14	150	20	
742- 1680	16	80	22	
742- 1610	16	100	22	
742- 1612	16	125	22	
742- 1615	16	150	22	
742- 2080	20	80	25	
742- 2010	20	100	25	
742- 2012	20	125	25	
742- 2015	20	150	25	